

720B-DM

SFIC: Solid Brass Cam Lock
Direct Drive for Small Format
Interchangeable Core



BEST compatible interchangeable core cylinders

SPECIFICATIONS

Retrofits: Best 1E7D4
Cams: Will work with Best original cams
Cylinder diameter: 1-1/8"
Across flats: 7/8"
Max. material thickness: 1-1/8"
Min. material thickness: 0.08"
Functions: Direct drive screw on cam mechanism
Body: Machined solid brass
Finish: US26D
Packaged: Packed 10 per box

KEYING INFORMATION

Cores: Not included.
Accepts: Best, Arrow, Falcon, KSP, Schlage SFIC or equivalent small format interchangeable cores
Compatible electronic cylinders: Medeco Nexgen XT or VIDEX CyberLock SFIC cylinders

INCLUDES

725-PA plastic thumbturn
 720-3-D1 short direct drive cam
 TR201 spacer collar, 1/8"
 TR202 spacer collar, 1/4"
 725-1 spacer for 6 pin cores



Works with Best original cams.

720B-DM

Function: Cam lock, direct drive screw on cam mechanism

Material: Solid brass machined body

Cam installation: See our website for cam assembly instructions.

INCLUDED ACCESSORIES

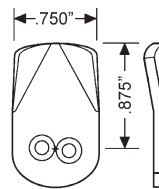

720-3-D1
short cam



TR201
1/8"



TR202
1/4"

720B-DM

SFIC: Solid Brass Cam Lock
Direct Drive for Small Format
Interchangeable Core

OPTIONAL ACCESSORIES - See our website for a complete list of optional components.

Optional Cams

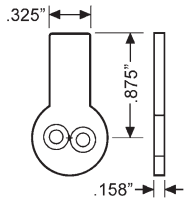

720-3-SC1
switch cam

CL-MP-118 Double-D Metal Punch

Hole size: Punches a DOUBLE "D" hole size
 approximately 7/8" wide by 1-1/8" high.



TR200 Series Trim Collars



TR203
3/8"

TR204
5/32"

206/207 Series SFIC Cylinders

Best compatible 6 and 7 pin small format interchangeable core cylinders



For BEST style
interchangeable
core cylinders



A	B	C	D	E	F	G	H	
J	K	L	M	Q	1C	1D	KMT300	

DIMENSIONS

MOUNTING CUTOUT

